

**BAVARIA 46** (1998 renewed 2006)

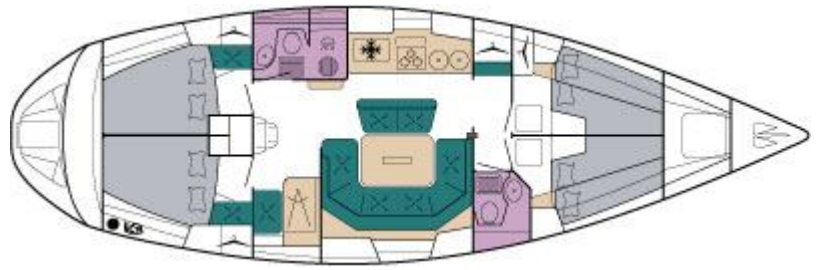



## **BAVARIA 46-FILOTIMO.**

**Build 1998/Revised 2006**

LENGTH:	14,48 M
BEAM:	04,48 M
DRAFT:	02,00 M
ENGINE:	VOLVO 60HP
CABINS:	4 (2 double / 2 triple / 2 saloon)
BERTHS:	12
HEADS:	2
SHOWERS:	3
SAILS:	ROLLER
DIESEL CAP:	230lt
WATER CAP:	600lt
WARM WATER :	YES
HOLDING TANK:	YES
BOW THRUSTER:	YES
ELECTRIC FRIDGE:	YES
BIMINI:	YES
SPRAYHOOD:	YES
VHF/DSC:	YES
EPIRB:	YES
GPS PLOTTER:	YES
CD/MP3 PLAYER-COCKPIT SPEAKERS:	YES
NAVTEX:	YES
GALLEY:	FULL EQUIPPED
GAS/SMOKE ALARM:	YES
WIND INSTRUMENTS:	YES
AUTOPILOT:	YES
ELECTRIC ANCHOR WINCH/AFT REM:	YES
DINGHY:	YES
OUTBOARD:	YES NEW ON 2010
CHARGE/CONVERTER 220V:	YES
WOODEN GANGWAY:	YES
COCKPIT CUSHIONS:	YES
TV:	YES
DVD / CHECK IN:	YES
SOLAR PANELS FOR REFRIGERATOR:	YES
AIR-CONDITION/DEHUMIDIFIER/IONIZER-HEATING:	YES
SNORKELLING-EQUIPMENT:	YES

**We are the first buyers and we keep the yacht dry for 5 months per year also has anti osmosis and extra electrolysis protection. The sails are new**